

— SITE PREPARATION 16

www.estairs.co.uk



SITE PREPARATION

SLAB REQUIREMENT

Concrete

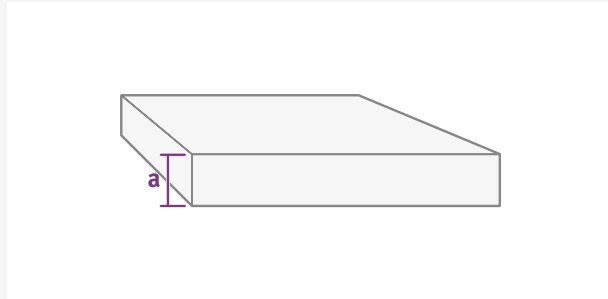

a: Minimum Depth: **250mm**

Timber Beam or Timber Double Joisted

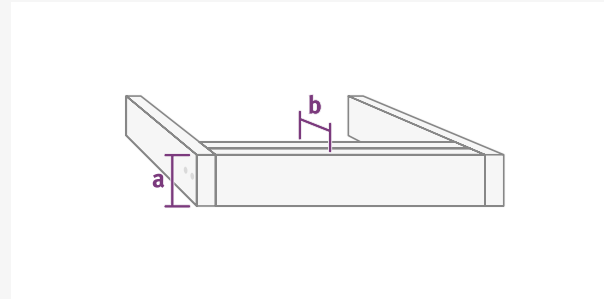

a: Minimum Depth: **250mm**
b: Minimum Thickness: **100mm**

I Beam

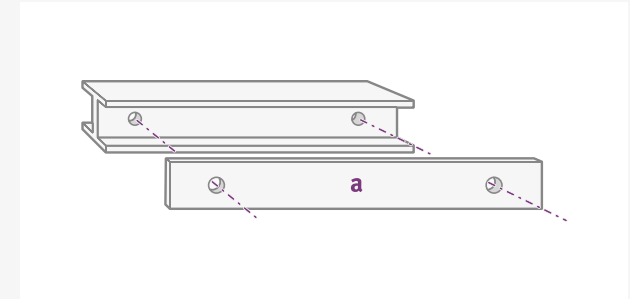

a: Timber infill must be through bolted

Face fix glass balustrade

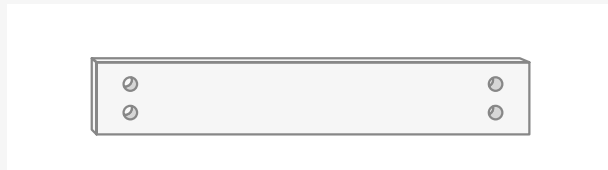

10mm steel plate; Max depth **450mm**



10mm steel plate fitted to face of slab to spread load.

Helical staircase

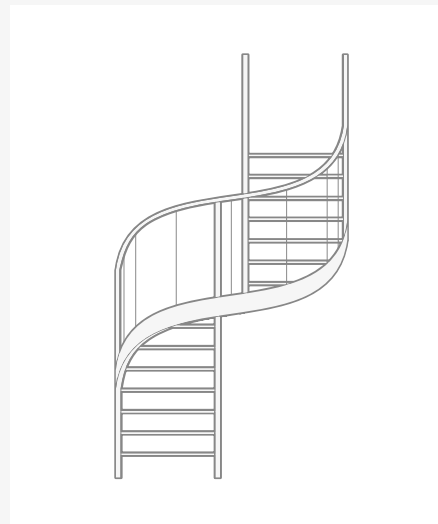

Helical staircases (curved with two stringers) in use are under stress to push outwards and therefore require :-

- A very strong fixing at landing floor, preferably a steel plate. (see drawing opposite)
- At the foot of the curved staircase a reinforced concrete base is always recommended, size and depth of this concrete base should be determined by a structural engineer.
- Depending on support available from adjacent bearing walls a support post at the curved section may be required.

STAIR SUPPORT

BEARING WALL

Stringer 1

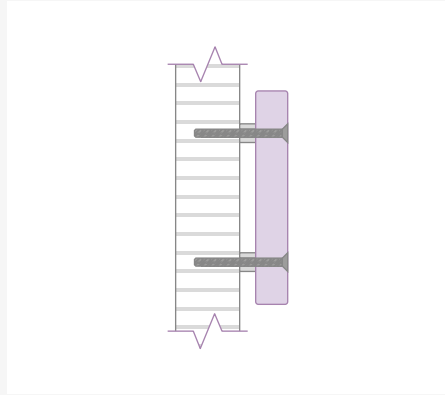

Minimum wall thickness: **200mm**
Stringer set **10mm** off wall

Stringer 2

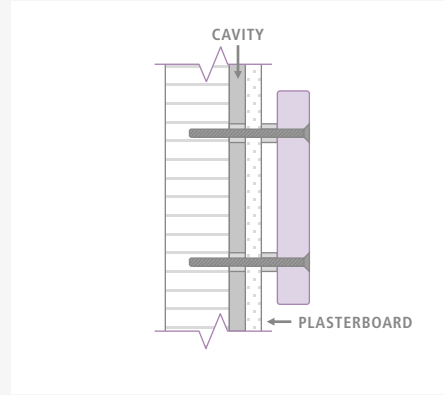

Max cavity: **20mm**

Stringer 3

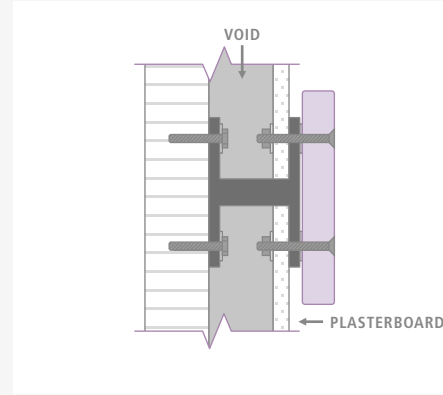

Max void: **200mm**

Post to wall

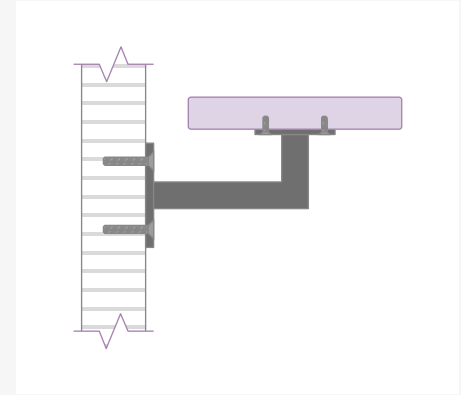

Min wall thickness: **200mm**

NON BEARING WALL

Support built inside wall

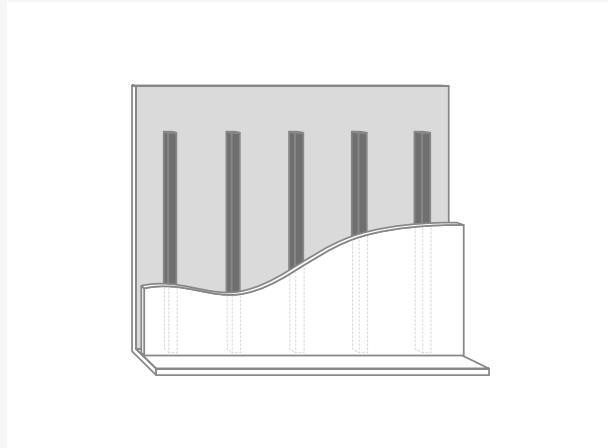

Post to ground

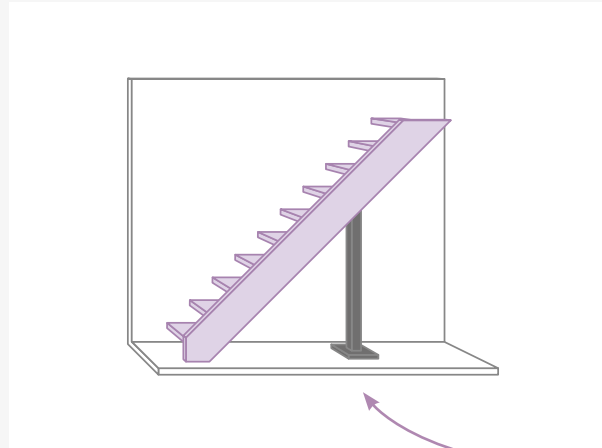

Floor Fixing

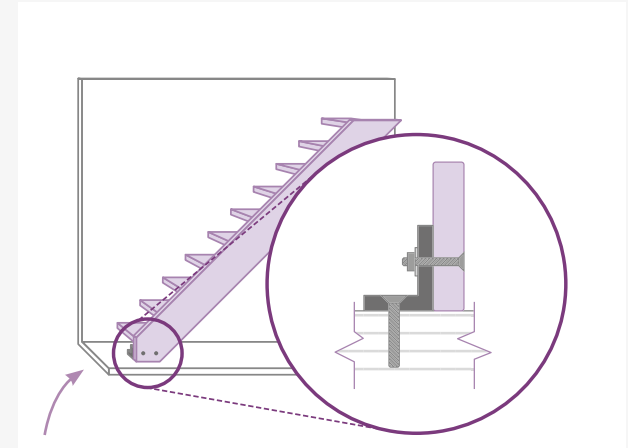

N.B. No heating pipes should run under floor fixings

CANTILEVER STAIRCASES

DESIGNER RANGE

When considering designer staircases attention should be paid to the following;

— Cantilever Staricases



Cantilever staircases can only be fitted to a level bearing wall.
A steel frame is fixed to the wall below the finished surface

Min wall thickness: **250mm**

Max tread width: **1200mm**

Max tread depth: **100mm**

— Alternative Method



Single "Z" shaped stringer fixed to face of wall

CANTILEVER STAIRCASES

TRADE RANGE - AKURA

Akura HR



Marking out

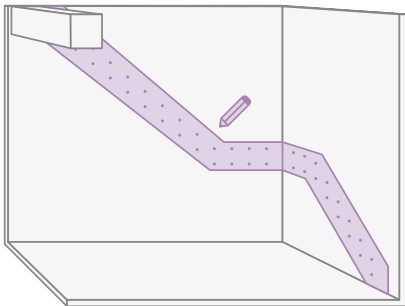

Max Height: **3500mm**
Use template to mark out holes

Suitable wall

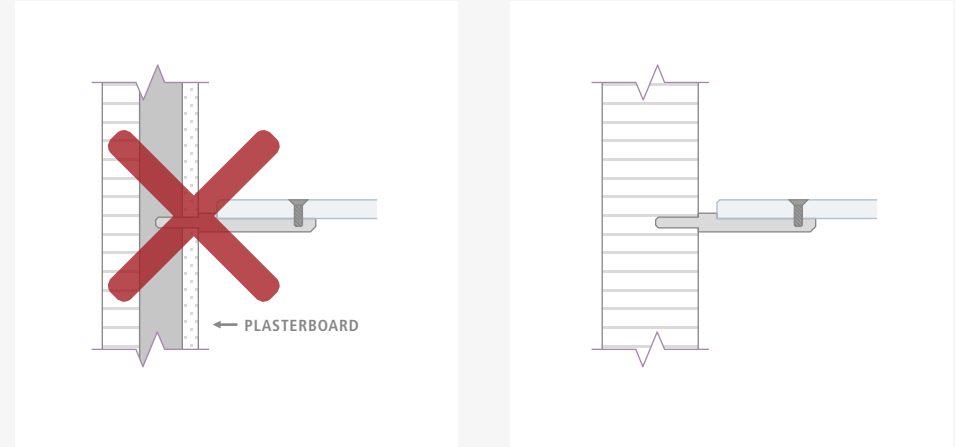

Must be a bearing wall
Min wall thickness: **120mm**

Fixing supports

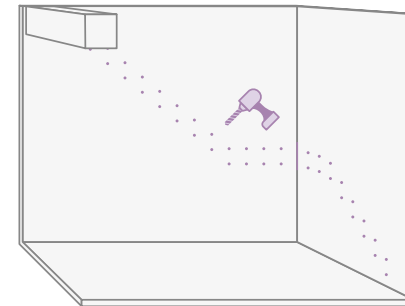

Drill holes and fix supports with resin anchor